

Photodetector Amplified InGaAs DC-800MHz

0.9-1.67 μm , fiber coupled



DATASHEET

[Return to the Webpage](#)



The AMDT amplified photodetector offers wide bandwidth operation from DC to 800 MHz and is available in two spectral ranges: 0.9–1.67 μm and 0.4–0.98 μm , with fiber-coupled optical input. It integrates a built-in amplifier with fixed gain, optimized for stable and reliable performance. The detector is compatible with standard SM1-threaded optical accessories and provides an RF output through an SMA connector, designed to drive 50 Ω load impedance. Power is supplied via a ± 5 V input through a J1 (2.54 mm, 3-pin) connector, with the power supply included.

Features

- DC- 800Mhz
- Low Noise
- Fiber Coupled
- Plug-Play Module

Specifications

Parameter	Min	Typical	Max	Unit
Detector Diameter		0.2		μm
Wavelength Response	900		1670	nm
Operation Bandwidth	DC		800	MHz
Peak Response (@1550)		1.3		A/W
Gain	0	25	50	dB
NEP (measured @uncooled)	1.3		8.3	$\text{pW}/\text{Hz}^{1/2}$
Output Offset		20	45	mV
Output Offset Drift (70dB)			3	$\text{mV}/^\circ\text{C}$
Optical Damage Threshold	50			mW
Operating Temperature	0		30	$^\circ\text{C}$
Power Supply \pm 5V		5		W
Weight		0.5		lbs
Signal Output		SMA		

Applications

- General Lab Use
- Instruments

Note: The specifications provided are for general applications with a cost-effective approach. If you need to narrow or expand the tolerance, coverage, limit, or qualifications, please [\[click this link\]](#):

Legal notices: All product information is believed to be accurate and is subject to change without notice. Information contained herein shall legally bind Agiltron only if it is specifically incorporated into the terms and conditions of a sales agreement. Some specific combinations of options may not be available. The user assumes all risks and liability whatsoever in connection with the use of a product or its application.

Rev 04/23/26

[P +1 781-935-1200](tel:+17819351200)

[E sales@agiltron.com](mailto:sales@agiltron.com)

[W www.agiltron.com](http://www.agiltron.com)

Photodetector Amplified InGaAs DC-800MHz

0.9-1.67 μm , fiber coupled



DATASHEET

Mechanical Dimensions (mm)

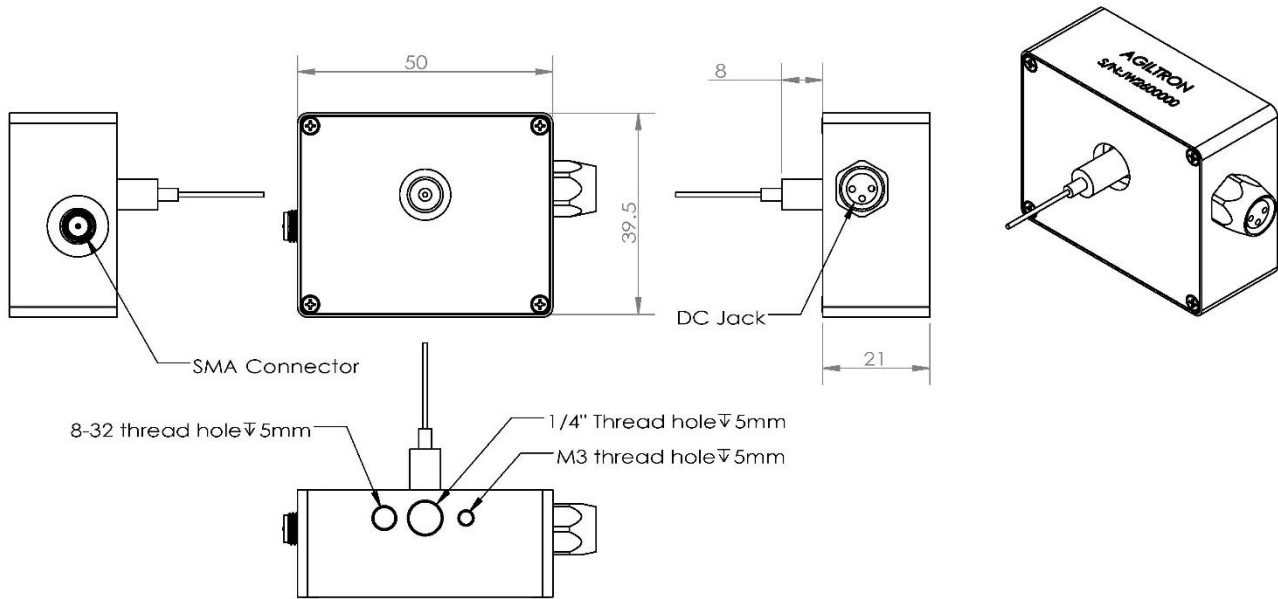

Photodetector Amplified InGaAs DC-800MHz

0.9-1.67 μm , fiber coupled



DATASHEET

Noise Level

Gain Bandwidth @1MHz (typical)

Spectral Response

Photodetector Amplified InGaAs DC-800MHz

0.9-1.67 μm , fiber coupled



DATASHEET

Ordering Information (Part Number) System

Prefix	Type	Wavelength	Configure	Fiber Type	Fiber Cover	Fiber Length	Connector ^[1]	Power Supply
AMPD-	InGaAs = 2	900-1670nm = 1 Special = 0	Regular = 1 Special = 0	SM28 = 1 Special = 0	0.9mm = 1 Special = 0	0.25m = 1 Special = 0	FC/PC = 1 Special = 0	Yes = 1 None = 2

[1]. The connector cannot be installed directly onto bare fiber, as it is prone to damage during shipping. However, the connector can be assembled on bare fiber if a 3 cm protective loose tube is added for reinforcement. The customer can remove this protective tube after testing. The optical power handling of a standard connector is less than 0.5 W for SM28 fiber and decreases further with smaller core fibers.

Accessories